



| English | Français | Deutsch | Italiano | Español |
|----------------------------|-----------------------------------|----------------------------|-------------------------------------|---------------------------|
| Dome head | Tête plate | Flachrundkopf | Testa tonda | Cabeza alomada |
| Low carbon steel* | Acier à faible teneur en carbone* | Stahl* | Acciaio a basso tenore di carbonio* | Acero bajo en carbono* |
| Zinc plated | Revêtement zingué | Verzinkt | Zincato | Zincado |
| Clear trivalent passivated | Passivation claire trivalente | Klar chromatiert, Cr6-frei | Passivazione chiara trivalente | Pasivado claro trivalente |

* : BS 3111 Type 0, SAE 1008, DIN 1654 Qst 34-3

Optional on request / sur demande / auf Anfrage / su richiesta / bajo petición:

Tin plated: replace part no. 01722 with 01723. / Etamé: remplacer la série 01722 par 01723. / Verzinnt: ersetzen Sie 01722 durch 01723. Stagnato: sostituire 01722 con 01723. / Estañado: cambiar 01722 por 01723.

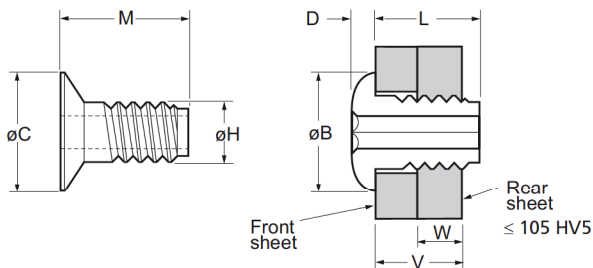

| ø | øH | Front sheet pièce à fixer / oberes Bauteil / piastra frontale/ pieza anterior | | Rear sheet pièce support/ unteres Bauteil/ piastra posteriore / pieza posterior | | øC | M | W | V | øB ¹⁾ | D ¹⁾ | L | Fasteners per pod Nombre de rivets par chargeur/ Niete pro Magazin/ Rivetti per caricatore / Uds./carga ± 1 | Part No/ref | |
|-----|-----|---|------|---|------|-----|------|------|-------|------------------|-----------------|-----|---|-------------|-------------|
| | | min. | max. | min. | max. | | | | | | | | | | |
| 2.8 | 2.6 | 2.95 | 3.02 | 2.62 | 2.70 | 5.9 | 5.2 | 1.62 | 2.85 | 6.1 | 1.4 | 4.0 | 62 | 01722-02806 | |
| | | | | | | | 6.2 | | 3.85 | | | | 5.0 | 52 | 01722-02807 |
| | | | | | | | 7.2 | | 4.83 | | | | 6.0 | 43 | 01722-02809 |
| | | | | | | | 8.2 | | 5.82 | | | | 7.0 | 38 | 01722-02810 |
| | | | | | | | 10.1 | | 7.80 | | | | 9.0 | 30 | 01722-02812 |
| 3.0 | 2.8 | 3.07 | 3.15 | 2.82 | 2.89 | 5.9 | 5.2 | 1.62 | 2.85 | 6.1 | 1.4 | 4.0 | 62 | 01722-03006 | |
| | | | | | | | 6.2 | | 3.85 | | | | 5.0 | 52 | 01722-03007 |
| | | | | | | | 7.2 | | 4.83 | | | | 6.0 | 43 | 01722-03009 |
| | | | | | | | 8.2 | | 5.82 | | | | 7.0 | 38 | 01722-03010 |
| | | | | | | | 9.2 | | 6.81 | | | | 8.0 | 34 | 01722-03011 |
| | | | | | | | 10.1 | | 7.80 | | | | 9.0 | 30 | 01722-03012 |
| | | | | | | | 13.1 | | 10.72 | | | | 11.9 | 23 | 01722-03016 |

all dimensions in mm / en milimètres / alle Maße in mm / in millimetri / en milímetros

1) Dimensions B and D are generated during the installation process and should only be used as an indication of the minimum space required.

Les cotes B et D ne sont données qu'à titre et représentent l'encombrement maximal de la tête du Rivscrow après pose.

Maße B und D werden während der Verarbeitung erzeugt und sollten nur als Anhaltspunkt für den minimalen Platzbedarf verwendet werden.

Le dimensioni B e D sono generate durante il processo d'installazione e devono essere usate solo come un'indicazione del minimo spazio richiesto.

Las dimensiones B y D se conforman en el proceso de colocación y deben tomarse como orientativas para comprobar el espacio mínimo necesario.

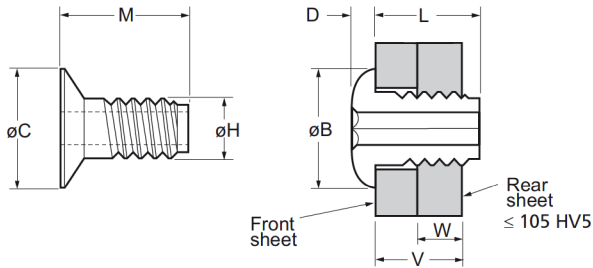

| Ø | ØH | Front sheet | | Rear sheet | | ØC | M | W | V | ØB ¹⁾ | D ¹⁾ | L | Fasteners per pod Nombre de rivets par chargeur/ Niete pro Magazin/ Rivetti per caricatore / Uds./carga ± 1 | Part No/ref |
|------|------|--|---|------------|------|------|------|------|-------|------------------|-----------------|------|--|-------------|
| | | pièce à fixer / oberes Bauteil / piastra frontale/ pieza anterior | pièce support/ unteres Bauteil/ piastra posteriore / pieza posterior | min. | max. | | | | | | | | | |
| nom. | max. | min. | max. | min. | max. | max. | max. | min. | max. | max. | max. | max. | | |
| 3.5 | 3.1 | 3.50 | 3.58 | 3.10 | 3.17 | 6.0 | 5.2 | 1.62 | 2.85 | 6.1 | 1.4 | 4.0 | 62 | 01722-03506 |
| | | | | | | | 6.2 | | 3.85 | | | 5.0 | 52 | 01722-03507 |
| | | | | | | | 7.2 | | 4.83 | | | 6.0 | 43 | 01722-03509 |
| | | | | | | | 8.2 | | 5.82 | | | 7.0 | 38 | 01722-03510 |
| | | | | | | | 9.2 | | 6.81 | | | 8.0 | 34 | 01722-03511 |
| | | | | | | | 10.1 | | 7.80 | | | 9.0 | 30 | 01722-03512 |
| | | | | | | | 14.1 | | 11.76 | | | 12.9 | 21 | 01722-03517 |
| 4.0 | 3.6 | 4.19 | 4.27 | 3.61 | 3.68 | 6.3 | 5.2 | 1.62 | 2.85 | 6.4 | 1.4 | 4.0 | 62 | 01722-04006 |
| | | | | | | | 6.2 | | 3.85 | | | 5.0 | 52 | 01722-04007 |
| | | | | | | | 7.2 | | 4.83 | | | 6.0 | 43 | 01722-04009 |
| | | | | | | | 8.2 | | 5.82 | | | 7.0 | 38 | 01722-04010 |
| | | | | | | | 9.2 | | 6.81 | | | 8.0 | 34 | 01722-04011 |
| | | | | | | | 10.1 | | 7.80 | | | 9.0 | 30 | 01722-04012 |
| | | | | | | | 12.1 | | 9.78 | | | 11.0 | 25 | 01722-04015 |

all dimensions in mm / en milimètres / alle Maße in mm / in millimetri / en milímetros



1) Dimensions B and D are generated during the installation process and should only be used as an indication of the minimum space required.

Les cotes B et D ne sont données qu'à titre et représentent l'encombrement maximal de la tête du Rivscrow après pose.

Maße B und D werden während der Verarbeitung erzeugt und sollten nur als Anhaltspunkt für den minimalen Platzbedarf verwendet werden.

Le dimensioni B e D sono generate durante il processo d'installazione e devono essere usate solo come un'indicazione del minimo spazio richiesto.

Las dimensiones B y D se conforman en el proceso de colocación y deben tomarse como orientativas para comprobar el espacio mínimo necesario.

| Ø |  |  | Hex Key Size Dim. clef 6 pans Sechskantgröße Dim. chiave esagonale llave Allen |
|------|---|---|--|
| nom. | kN | kN | |
| 2.8 | 0.90 | 0.70 | 1.60 (1/16") |
| 3.0 | 0.90 | 0.80 | 1.60 (1/16") |
| 3.5 | 1.00 | 1.00 | 2.0 (5/64") |
| 4.0 | 1.30 | 1.20 | 2.5 |



| English | Français | Deutsch | Italiano | Español |
|----------------------------|-----------------------------------|----------------------------|-------------------------------------|---------------------------|
| Dome head | Tête plate | Flachrundkopf | Testa tonda | Cabeza alomada |
| Low carbon steel* | Acier à faible teneur en carbone* | Stahl* | Acciaio a basso tenore di carbonio* | Acero bajo en carbono* |
| Zinc plated | Revêtement zingué | Verzinkt | Zincatura | Zincado |
| Clear trivalent passivated | Passivation claire trivalente | Klar chromatiert, Cr6-frei | Passivazione chiara trivalente | Pasivado claro trivalente |

* : SAE 1008

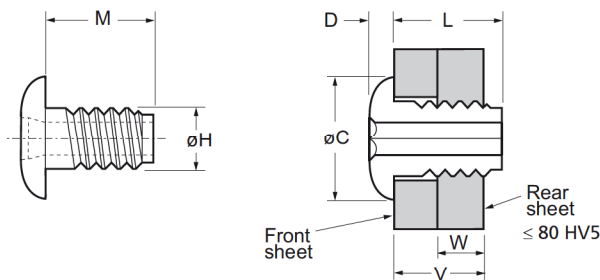

| ø | øH | Front sheet | | Rear sheet | | M | øC | D | W | V | L | Hex Key Size Dim. clef 6 pans / Sechskantgröße / Dim. chiave esagonale / llave Allen | Fasteners per pod Nombre de rivets par chargeur / Niete pro Magazin / Rivetti per caricatore / Uds./carga ± 1 | Part No/ref |
|------|------|-------------|------|------------|------|-------------|------|------|------|-------------|-------------|--|--|----------------------------|
| | | min. | max. | min. | max. | | | | | | | | | |
| nom. | max. | min. | max. | min. | max. | max. | max. | max. | min. | max. | max. | | | |
| 4.8 | 4.48 | 4.90 | 5.00 | 4.50 | 4.60 | 8.4 13.3 | 9.5 | 1.7 | 2.8 | 6.5 11.5 | 8.7 13.5 | 2.5 | 28 19 | 01733-04810 01733-04816 |

all dimensions in mm / en milimètres / alle Maße in mm / in millimetri / en milímetros



| English | Français | Deutsch | Italiano | Español |
|----------------------------|-----------------------------------|----------------------------|-------------------------------------|---------------------------|
| Dome head | Tête plate | Flachrundkopf | Testa tonda | Cabeza alomada |
| Low carbon steel* | Acier à faible teneur en carbone* | Stahl* | Acciaio a basso tenore di carbonio* | Acero bajo en carbono* |
| Zinc plated | Revêtement zingué | Verzinkt | Zincatura | Zincado |
| Clear trivalent passivated | Passivation claire trivalente | Klar chromatiert, Cr6-frei | Passivazione chiara trivalente | Pasivado claro trivalente |

* : BS 31110 Type 0, SAE 1008, DIN 1654 QSt 34-3

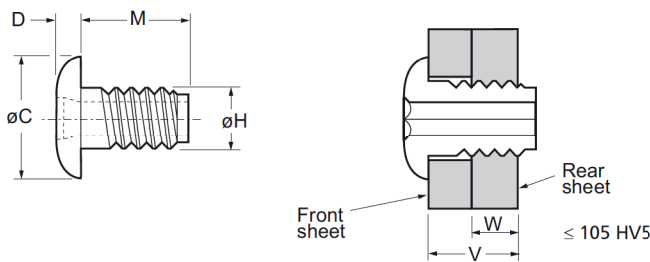

| ø | øH | Front sheet | | Rear sheet | | M | øC | D | W | V | Hex Key Size Dim. clef 6 pans / Sechskantgröße / Dim. chiave esagonale / llave Allen | Torque-to-turn tenue au couple / Verdrehmoment / coppia di rotazione / resistencia al giro Nm | Fasteners per pod Nombre de rivets par chargeur / Niete pro Magazin / Rivetti per caricatore / Uds./carga ± 1 | Part No/ref |
|-----|------|-------------|------|------------|------|------|-----|-----|------|------|--|--|--|-------------|
| | | nom. | max. | min. | max. | | | | | | | | | |
| 2.8 | 2.60 | 2.95 | 3.02 | 2.62 | 2.70 | 4.2 | 6.2 | 1.2 | 1.62 | 3.15 | 1.60 (1/16") | 0.28 | 62 | 01772-02806 |
| | | | | | | 6.2 | | | | 4.17 | | | | |
| | | | | | | 7.2 | | | | 5.18 | | | | |
| | | | | | | 7.3 | | | | 6.17 | | | | |
| | | | | | | 9.8 | | | | 8.79 | | | | |
| 3.0 | 2.82 | 3.07 | 3.15 | 2.82 | 2.89 | 4.2 | 6.2 | 1.2 | 1.62 | 3.15 | 1.60 (1/16") | 0.28 | 62 | 01772-03006 |
| | | | | | | 5.2 | | | | 4.17 | | | | |
| | | | | | | 6.2 | | | | 5.18 | | | | |
| | | | | | | 7.3 | | | | 6.17 | | | | |
| | | | | | | 8.9 | | | | 7.87 | | | | |
| | | | | | | 9.8 | | | | 8.79 | | | | |
| 3.5 | 3.09 | 3.50 | 3.58 | 3.10 | 3.17 | 4.2 | 6.2 | 1.2 | 1.62 | 3.15 | 2.0 (5/64") | 0.56 | 62 | 01772-03506 |
| | | | | | | 5.2 | | | | 4.17 | | | | |
| | | | | | | 6.2 | | | | 5.18 | | | | |
| | | | | | | 7.3 | | | | 6.17 | | | | |
| | | | | | | 8.9 | | | | 7.87 | | | | |
| | | | | | | 9.8 | | | | 8.79 | | | | |
| 4.0 | 3.60 | 4.19 | 4.27 | 3.61 | 3.68 | 4.2 | 6.2 | 1.2 | 1.62 | 2.85 | 2.50 | 0.62 | 62 | 01772-04006 |
| | | | | | | 5.2 | | | | 3.85 | | | | |
| | | | | | | 6.2 | | | | 4.83 | | | | |
| | | | | | | 7.3 | | | | 5.82 | | | | |
| | | | | | | 8.2 | | | | 6.81 | | | | |
| | | | | | | 9.2 | | | | 7.80 | | | | |
| | | | | | | 11.2 | | | | 9.78 | | | 25 | 01772-04015 |

all dimensions in mm / en milimètres / alle Maße in mm / in millimetri / en milímetros



| English | Français | Deutsch | Italiano | Español |
|----------------------------|-----------------------------------|----------------------------|-------------------------------------|---------------------------|
| Dome head | Tête bombée | Flachrundkopf | Testa tonda | Cabeza alomada |
| Low carbon steel* | Acier à faible teneur en carbone* | Stahl* | Acciaio a basso tenore di carbonio* | Acero bajo en carbono* |
| Zinc plated | Zingué | Verzinkt | Zincato | Zincado |
| Clear trivalent passivated | Passivation claire trivalente | Klar chromatiert, Cr6-frei | Passivazione chiara trivalente | Pasivado claro trivalente |

* : BS 3111 Type 0, SAE 1008, DIN 1654 Qst 34-3

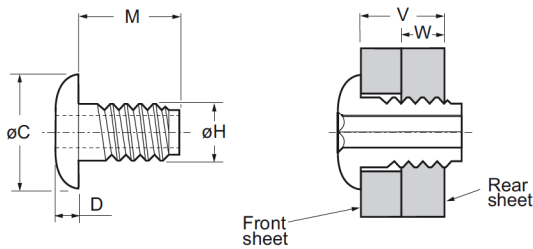

| ø | øH | Front sheet Pièce à fixer oberes Bauteil piastra frontale pieza anterior | | Rear sheet Pièce support unteres Bauteil piastra posteriore pieza posterior | | øC | D | M | W | V | Hex Key Size Dim. clef 6 pans/ Sechskantgröße/ Dim. chiave esagonale / llave Allen | Part No/ref |
|-----|------|--|------|---|------|-----|-------|-------|-------|-----------------|---|-------------|
| | | min. | max. | min. | max. | | | | | | | |
| 3.0 | 2.81 | 3.28 | 3.35 | 2.82 | 2.90 | 6.2 | 1.19 | 6.93 | 2.79 | 5.46 | 1.60 (1/16") | 01742-03008 |
| | | | | | | | | 10.11 | | 8.64 | | 01742-03012 |
| | | | | | | | | 13.28 | | 11.81 | | 01742-03016 |
| 3.5 | 3.09 | 3.53 | 3.63 | 3.10 | 3.18 | 6.2 | | 6.93 | 5.46 | 1.60 (1/16") | 01742-03508 | |
| | | | | | | | | 10.11 | 8.64 | | 01742-03512 | |
| | | | | | | | | 13.28 | 11.81 | | 01742-03516 | |
| 4.0 | 3.39 | 4.09 | 4.17 | 3.40 | 3.47 | 8.1 | | 6.93 | 5.46 | 2.00 (5/64") | 01742-04008 | |
| | | | | | | | | 10.11 | 8.64 | | 01742-04012 | |
| | | | | | | | | 13.28 | 11.81 | | 01742-04016 | |
| 4.5 | 3.99 | 4.93 | 5.00 | 4.00 | 4.08 | 8.1 | 6.93 | 5.46 | 2.50 | 01742-04508 | | |
| | | | | | | | 10.11 | 8.64 | | 01742-04512 | | |
| | | | | | | | 13.28 | 11.81 | | 01742-04516 | | |

all dimensions in mm / en millimètres / alle Maße in mm / in millimetri / en milímetros